

RISPERDAL®

Consumer Medicine Information (CMI) summary

The [full CMI](#) on the next page has more details. If you are worried about using this medicine, speak to your doctor or pharmacist.

1. Why am I using RISPERDAL?

RISPERDAL contains the active ingredient Risperidone. RISPERDAL belongs to a group of medicines called antipsychotic agents which improve the symptoms of certain types of mental illness.

For more information, see Section [1. Why am I using RISPERDAL?](#) in the full CMI.

2. What should I know before I use RISPERDAL?

Do not use if you have ever had an allergic reaction to risperidone or any of the ingredients listed at the end of the CMI.

Talk to your doctor if you have any other medical conditions, have an eye surgery planned, take any other medicines, or are pregnant or plan to become pregnant or are breastfeeding.

For more information, see Section [2. What should I know before I use RISPERDAL?](#) in the full CMI.

3. What if I am taking other medicines?

Some medicines may interfere with RISPERDAL and affect how it works.

A list of these medicines is in Section [3. What if I am taking other medicines?](#) in the full CMI.

4. How do I use RISPERDAL?

RISPERDAL is available as oral tablets and a solution for oral use. Your doctor will decide a dose suitable for you based on your condition and response. Always follow your doctor's instructions carefully and seek your doctor's advice before changing or stopping treatment. Never take more tablets or solution than your doctor tells you to take.

RISPERDAL oral solution comes with a pipette. Use only the pipette delivered with this medicine for measuring the dose prescribed by your doctor.

More instructions can be found in Section [4. How do I use RISPERDAL?](#) in the full CMI.

5. What should I know while using RISPERDAL?

Things you should do	<ul style="list-style-type: none">Remind any doctors, dentists, and pharmacists you visit that you are using RISPERDAL.Tell your doctor immediately if you notice any involuntary movements of the tongue, mouth, cheeks or jaw which may progress to the arms and legs.Be careful during strenuous exercise or exposure to extreme heat. Try to drink plenty of water.
Things you should not do	<ul style="list-style-type: none">Do not use RISPERDAL if the appearance of the tablets or the oral solution has changed or does not look right.
Driving or using machines	<ul style="list-style-type: none">Be careful before you drive or use any machines or tools until you know how RISPERDAL affects you. RISPERDAL may cause dizziness or light-headedness in some people, especially after the first dose
Drinking alcohol	<ul style="list-style-type: none">Do not drink alcohol. RISPERDAL can increase the effects of alcohol.
Looking after your medicine	<ul style="list-style-type: none">RISPERDAL 0.5 mg tablets: Store below 30°C. Protect from light. RISPERDAL 1mg, 2mg, 3mg, 4 mg tablets: Store below 25°C. Protect from light.Store RISPERDAL oral solution below 30°C. Do not refrigerate.

For more information, see Section [5. What should I know while using RISPERDAL?](#) in the full CMI.

6. Are there any side effects?

Like all medicines, RISPERDAL can cause side effects. If you do experience any side effects, most of them are minor and temporary. However, some side effects may need medical attention and some may require urgent care.

For more information on common side effects and other serious side effects, including what to do if you have any side effects, see Section [6. Are there any side effects?](#) in the full CMI.

RISPERDAL®

Active ingredient(s): *Risperidone*

Consumer Medicine Information (CMI)

This leaflet provides important information about using RISPERDAL. **You should also speak to your doctor or pharmacist if you would like further information or if you have any concerns or questions about using RISPERDAL.**

Where to find information in this leaflet:

- [1. Why am I using \[medicine name\]?](#)
- [2. What should I know before I use \[medicine name\]?](#)
- [3. What if I am taking other medicines?](#)
- [4. How do I use \[medicine name\]?](#)
- [5. What should I know while using \[medicine name\]?](#)
- [6. Are there any side effects?](#)
- [7. Product details](#)

1. Why am I using RISPERDAL?

RISPERDAL contains the active ingredient risperidone.

RISPERDAL belongs to a group of medicines called antipsychotic agents which improve the symptoms of certain types of mental illness.

RISPERDAL is used for the:

- **treatment of sudden (acute) and long-term (chronic) schizophrenia and other types of related psychoses.** These are disorders related to thought, feeling and/or action,
- **treatment of mania associated with bipolar disorder.** This condition is characterised by symptoms such as elevated, expansive or irritable mood, inflated self-esteem, decreased need for sleep, pressured speech, racing thoughts, distractibility or poor judgement including disruptive or aggressive behaviours,
- **treatment of behavioural problems in patients with a decline in mental ability (dementia) caused by Alzheimer's disease.** These problems include: aggression through words or action, morbid suspiciousness, agitation or wandering,
- **treatment of conduct and other disruptive behaviours** such as aggression, impulsiveness and self-injury in children (over 5 years old), adolescents and adults who are intellectually disabled,
- **treatment of behavioural symptoms of autism in children and adolescent.**

RISPERDAL helps to correct a chemical imbalance in the brain associated with these conditions.

This medicine has been approved for the uses mentioned above. However, your doctor may prescribe it for another use. It is only available with a doctor's prescription.

If you want more information, ask your doctor.

RISPERDAL is not addictive.

2. What should I know before I use RISPERDAL?

Warnings

Do not use RISPERDAL if:

- you are allergic to Risperidone, or any of the ingredients listed at the end of this leaflet.
- Always check the ingredients to make sure you can use this medicine.

Check with your doctor if you:

- **you have or have ever had any medical conditions, especially the following:**
 - heart problems, particularly irregular heart rhythm, abnormalities in electrical activity of the heart, high or low blood pressure, or you've had a heart attack or stroke in the past or heart failure.
 - unusual excessive sweating or diarrhoea, dehydration or problems with your body temperature regulation
 - kidney or liver problems
 - you are prone to dizziness when standing up from lying or sitting position
 - Parkinson's disease (a progressive movement and thinking disorder that tends to affect older people)
 - dementia or Lewy body dementia - older people suffering dementia may be at increased risk of stroke or death with RISPERDAL
 - sugar diabetes - unusual thirst, tiredness, blurred vision, upset stomach or need to urinate are common signs of high blood sugars
 - epilepsy, seizures or fits
 - continuous and/or painful erections (called 'priapism')
 - involuntary movements or unusual restlessness or difficulty sitting still
 - suicidal thoughts or past suicide attempts
 - low blood potassium levels (hypokalaemia)
 - breast cancer
 - cancer of the pituitary gland
 - Tardive dyskinesia (a reaction to some medicines with uncontrollable twitching or jerking movements of the tongue, face, mouth, jaw, arms and legs)
 - Neuroleptic Malignant Syndrome (a serious reaction to some medicines that causes sudden increase in body temperature, very fast heartbeat, extremely high or low blood pressure and severe muscle stiffness or fits).
 - blood clots - tell your doctor if you or someone else in your family has a history of blood clots. Blood clots in the lungs and legs can occur with

RISPERDAL. Blood clots in the lungs can result in death.

- low white blood cell count - if you have low numbers of some white blood cells, your risk of contracting an infection or developing a fever is increased with RISPERDAL.

- **you have any eye surgery planned.**

During an operation on the eye for cloudiness of the lens (cataract), the pupil (the black circle in the middle of your eye) may not increase in size as needed. Also, the iris (the colored part of the eye) may become floppy during surgery and that may lead to eye damage. If you are planning to have an operation on your eye, make sure you tell your eye doctor that you are taking this medicine.

Your doctor will need to assess whether you are at risk of a surgical complication (called 'Intraoperative Floppy Iris Syndrome'). You may be recommended to stop your RISPERDAL temporarily prior to your eye surgery.

- **you will be in a hot environment or do a lot of vigorous exercise.**

RISPERDAL may make you sweat less, causing your body to overheat.

- take any medicines for any other condition.

During treatment, you may be at risk of developing certain side effects. It is important you understand these risks and how to monitor for them. See additional information under Section [6. Are there any side effects?](#)

Pregnancy and breastfeeding

Check with your doctor if you are pregnant or intend to become pregnant.

Your doctor will advise you whether you should take RISPERDAL. Shaking, muscle stiffness and/or weakness, sleepiness, agitation, breathing problems, or difficulty in feeding may occur in newborns, if a mother used RISPERDAL in the last trimester of her pregnancy.

Talk to your doctor if you are breastfeeding or intend to breastfeed.

As RISPERDAL is excreted in breast milk, it is recommended that you do not breast-feed while taking the medicine.

Children and adolescents

RISPERDAL cannot be recommended for use in children with schizophrenia under 15 years at the present time as there is little experience with the product in this group.

RISPERDAL cannot be recommended for use in children with disruptive behaviour disorders under 5 years at the present time as there is little experience with the product in this group.

Using it for the first time

At the start of treatment, you may have a fall in blood pressure making you feel dizzy on standing up, or your

heart may beat faster. These should go away after a few days. Tell your doctor if they continue or worry you.

3. What if I am taking other medicines?

Tell your doctor or pharmacist if you are taking any other medicines, including any medicines, vitamins or supplements that you buy without a prescription from your pharmacy, supermarket or health food shop.

Some medicines may interfere with RISPERDAL and affect how it works. In particular,

- RISPERDAL can enhance the effects of alcohol and medicines that reduce the ability to react (e.g., sleeping tablets, "tranquillisers", strong painkillers, certain antihistamines, certain antidepressants).

So don't drink alcohol and only take such medicines if your doctor prescribes them.
- Some medicines for treating Parkinson's disease (dopamine agonists, e.g. levodopa) may counteract RISPERDAL.
- medicines that increase the activity of the central nervous system (psychostimulants such as methylphenidate).
- other medicines to treat mental illness or psychotic conditions
- if you are taking medicines for high blood pressure, consult your doctor, as taking these medicines together with RISPERDAL may cause the blood pressure to drop too low.
- RISPERDAL should be used with caution when taking medications that may change the electrical activity of the heart, such as but not restricted to: medicines for malaria, heart rhythm disorders, allergies, other antipsychotics, antidepressants, water tablets or other medicines affecting body salts (sodium, potassium, magnesium).
- Taking RISPERDAL with furosemide, a medicine used to treat conditions such as heart failure and high blood pressure. There is an increased risk of side effects or death in older people if furosemide is also taken with RISPERDAL.
- medicines to treat epilepsy.

Some medicines, when they are taken together with RISPERDAL, may increase or decrease the level of RISPERDAL in your blood. Therefore, tell your doctor if you start and/or stop taking any of the below medicines, since your doctor may need to change the dose.

Medicines that may increase the level of RISPERDAL in your blood include:

- medicines to treat depression and various anxiety disorders, such as fluoxetine and paroxetine;
- medicines to treat fungal infections such as itraconazole and ketoconazole;
- certain medicines used in the treatment of HIV/AIDS, such as ritonavir;
- verapamil, a medicine used to treat high blood pressure and/or abnormal heart rhythm;
- sertraline and fluvoxamine, medicines used to treat depression and other psychiatric disorders.

Medicines that may reduce the level of RISPERDAL in your blood include:

- carbamazepine, a medicine mainly used for epilepsy or trigeminal neuralgia (severe pain attacks in the face);
- rifampicin, a medicine for treating some infections.

Check with your doctor or pharmacist if you are not sure about what medicines, vitamins or supplements you are taking and if these affect RISPERDAL.

4. How do I use RISPERDAL?

RISPERDAL comes in the form of oral tablets and a solution, both of which are to be taken only by mouth.

How much to take

It is very important that the correct amount of RISPERDAL should be taken, but this will vary from person to person. That is why your doctor will adjust the amount until the desired effect is obtained. So follow your doctor's instructions carefully and do not change or stop the required dosage without consulting your doctor first.

Important note: never take more tablets or solution than your doctor tells you to take.

Each millilitre (mL) of RISPERDAL oral solution contains 1 milligram (mg) of risperidone. For example, a 0.25 mg dose is 0.25 mL and a 0.5 mg dose is 0.5 mL. The dose in mg and the equivalent oral solution dosing in mL are provided below.

- **For Schizophrenia and Related Psychoses**

The usual starting dose of RISPERDAL is 1 mg (or 1 mL of solution) twice a day. This will be gradually increased by your doctor to suit your needs.

From then on, the dose can be taken once a day or twice a day according to your doctor's instructions.

- **For Elderly Patients with Schizophrenia or Related Psychoses**

For older patients a starting dose of 0.5 mg (or 0.5 mL of solution) twice a day is usual. This may be gradually increased by your doctor to suit your needs.

- **Patients with impaired kidney and liver function.**

If you have kidney or liver disease a starting dose of 0.5 mg (or 0.5 mL of solution) twice a day is usual. This may be gradually increased by your doctor to suit your needs.

- **For mania**

The recommended starting dose is 2 mg (or 2 mL of solution) once a day. This may be gradually increased by your doctor to suit your needs.

Your doctor may decide you should take another medicine called a mood stabiliser as well as RISPERDAL.

- **For Behavioural Problems in People with Dementia**

The usual starting dose is 0.25 mg (or 0.25 mL of solution) twice daily. This may be gradually increased by your doctor to suit your needs.

From then on, the dose can be taken once a day or twice a day according to your doctor's instructions.

- **For Disruptive Behaviour Disorders in Adults and Children**

- For people who weigh 50 kg or more, the usual starting dose is 0.5 mg (or 0.5 mL of solution) once a day. This may be gradually increased by your doctor to suit your needs.

- For people who weigh less than 50 kg, the usual starting dose is 0.25 mg (or 0.25 mL of solution) once a day. This may be gradually increased by your doctor to suit your needs.

- Your doctor will advise you on how much RISPERDAL you need.

- **For Behavioural Disorders Associated with Autism in Children and Adolescents**

- For people weighing less than 20kg the usual starting dose is 0.25mg (or 0.25 mL of solution). This may be gradually increased by your doctor to suit your needs.

- For people weighing 20kg or more the usual starting dose is 0.5mg (or 0.5 mL of solution). This may be gradually increased by your doctor to suit your needs.

- Your doctor will advise you on how much RISPERDAL you need.

When to take RISPERDAL

- RISPERDAL may be taken as a single dose, once a day or it may be taken in divided doses twice a day (in the morning and in the evening).
- You may take RISPERDAL either with or between meals.

How to take it

- **RISPERDAL Tablets:** Swallow RISPERDAL tablets with water or other liquid.
- **RISPERDAL oral solution:** Mix RISPERDAL oral solution with a non-alcoholic drink. Mineral water, orange juice, coffee and milk are suitable. Do not use tea.

Directions for opening the bottle and using the pipette for RISPERDAL Oral Solution

Always take this medicine exactly as your doctor has told you. Check with your doctor if you are not sure.

The solution comes with a syringe (pipette). Use only the syringe (pipette) delivered with this medicine for measuring the dose prescribed by your doctor.

Figure 1:

The bottle comes with a child-resistant cap, and should be opened as follows:

- To open, push the screw cap down while turning it anti-clockwise.

- Remove the unscrewed cap.

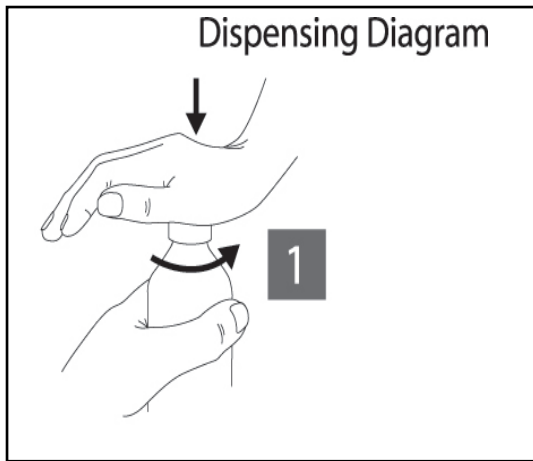

Figure 2:

Insert the pipette into the bottle.

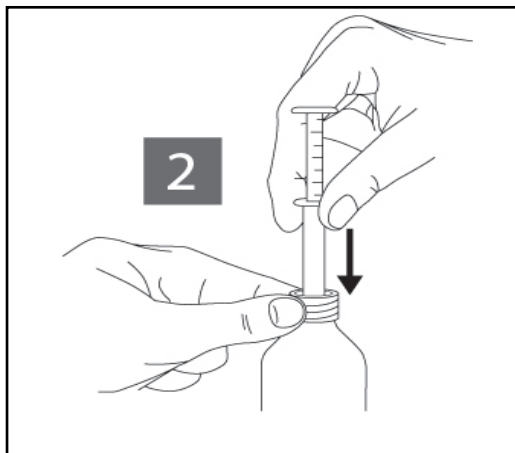
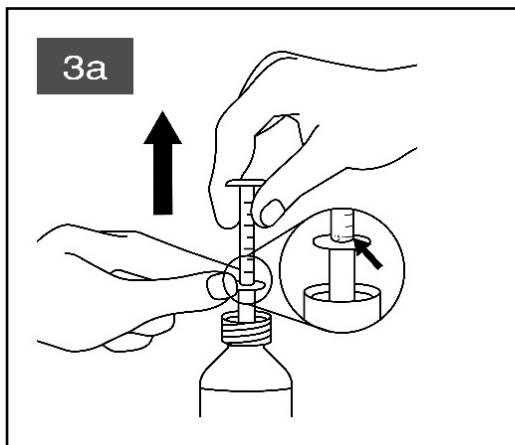

Figure 3:

While holding the bottom ring (Figure 3a), pull the top ring up to the mark that corresponds to the number of millilitres or milligrams you need to give (See examples Figure 3b).



Measure the exact dose of medicine you need. Pay attention when measuring a small dose, for example for 0.25 mg, measure 0.25 mL (a quarter millilitre); for 0.5 mg, measure 0.5 mL (half a millilitre).

1 mL of RISPERDAL oral solution contains 1 mg risperidone. The measured volume is printed every 0.25 mL / 0.25 mg on the plunger.

Figure 3b shows **examples** of prescribed doses and corresponding marks on the plunger.

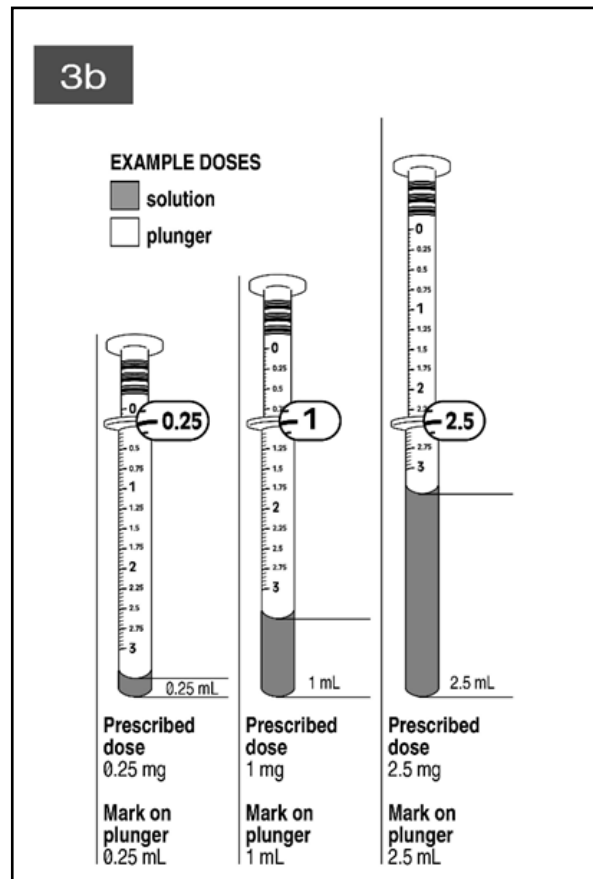
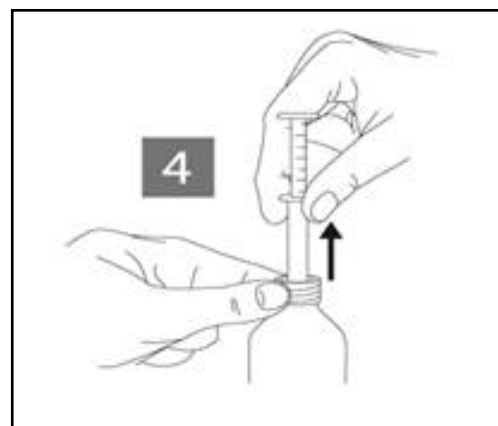

Figure 4:

Holding the bottom ring, remove the entire pipette from the bottle.

Empty the contents of the pipette into a non-alcoholic drink by sliding the upper ring down. Mineral water, orange juice, coffee and milk are suitable. Do not use tea.

Close the bottle. Rinse the pipette with some cold water after use, let it air dry and store it in its case. Use of detergents or extensive rubbing with a cloth may increase the risk of fading or disappearing print.



How long to take it

Continue taking the tablets or solution for as long as your doctor tells you.

RISPERDAL helps control your condition but does not cure it. Therefore, you must take RISPERDAL every day.

Do not stop taking it unless your doctor tells you to - even if you feel better.

If you forget to use RISPERDAL

RISPERDAL should be used regularly at the same time each day. If you miss your dose at the usual time, take the missed dose as soon as you remember instead of your next dose. Then go back to taking it as you would normally.

Do not take a double dose to make up for the one you missed.

If you forget to take RISPERDAL for a number of days or more, tell your doctor before starting your medicine again.

If you use too much RISPERDAL

If you think that you have used too much RISPERDAL, you may need urgent medical attention.

You should immediately:

- phone the Poisons Information Centre (in Australia telephone **13 11 26** and in New Zealand telephone **0800 POISON** or **0800 764 766**), or
- contact your doctor, or
- go to the Emergency Department at your nearest hospital.

Signs of overdose may include drowsiness, sleepiness, excessive trembling, excessive muscle stiffness, increased heart rate, very low blood pressure causing fainting or unconsciousness.

You should do this even if there are no signs of discomfort or poisoning.

5. What should I know while using RISPERDAL?

Things you should do

- **Follow your doctor's instructions carefully and seek your doctor's advice before changing or stopping treatment.**
- **Be careful during strenuous exercise or exposure to extreme heat. Try to drink plenty of water.**
- **Avoid excessive eating.** There is a possibility of weight gain when taking RISPERDAL. Your doctor may monitor your body weight or recommend strategies to assist with weight management.
- If you are pre-menopausal, tell your doctor if you do not have a period for more than six months while using RISPERDAL, even if you are not pregnant.

Call your doctor straight away if you:

- notice any involuntary movements of the tongue, mouth, cheeks or jaw which may progress to the arms and legs.

These may be symptoms of a condition called Tardive Dyskinesia, which can develop in people taking antipsychotic medicines, including RISPERDAL. This condition is more likely to occur during longer term treatment and in older women. In very rare cases,

these symptoms may be permanent. However, if detected early, these symptoms are usually reversible.

Remind any doctor, dentist or pharmacist you visit that you are using RISPERDAL.

Things you should not do

- Do not use RISPERDAL if the appearance of the tablets or the oral solution has changed or does not look right.

Driving or using machines

Be careful before you drive or use any machines or tools until you know how RISPERDAL affects you.

RISPERDAL may cause dizziness or light-headedness in some people, especially after the first dose. Make sure you know how you react to RISPERDAL before you drive a car, operate machinery, or do anything else that could be dangerous if you are dizzy.

If the medicine makes you feel light-headed, dizzy or faint, be careful when getting up from a sitting or lying position.

Getting up slowly may help.

Drinking alcohol

Do not drink alcohol.

RISPERDAL can increase the effects of alcohol.

Looking after your medicine

- **RISPERDAL 0.5 mg tablets:** Store below 30°C. Protect from light.
- **RISPERDAL 1 mg, 2 mg, 3 mg, 4 mg tablets:** Store below 25°C. Protect from light.
- **RISPERDAL oral solution:** Store below 30°C. Do not refrigerate.

Follow the instructions in the carton on how to take care of your medicine properly.

Store it in a cool dry place away from moisture, heat or sunlight; for example, do not store it:

- in the bathroom or near a sink, or
- in the car or on window sills.

Heat and dampness can destroy some medicines.

Keep it where young children cannot reach it.

Getting rid of any unwanted medicine

If you no longer need to use this medicine or it is out of date, take it to any pharmacy for safe disposal.

Do not use this medicine after the expiry date.

6. Are there any side effects?

All medicines can have side effects. If you do experience any side effects, most of them are minor and temporary. However, some side effects may need medical attention.

See the information below and, if you need to, ask your doctor or pharmacist if you have any further questions about side effects.

Less serious side effects

Less serious side effects	What to do
<p>difficulty thinking, working or carrying out your usual daily activities because of:</p> <ul style="list-style-type: none"> • headache • trembling, muscle weakness, unsteadiness on your feet, lack of coordination or slow, shuffling walk (symptoms of Parkinsonism). • lack of energy, drowsiness or excessive sleeping during the day, sleeplessness or difficulty in concentrating • difficulty speaking • blurred vision • fainting • dizziness • any problems with confusion or unsteadiness • pains in parts of your body, e.g. in the neck, back, ear, hands or feet • falling <p>muscle, joint, nerve or movement changes such as:</p> <ul style="list-style-type: none"> • shaking or trembling • fatigue or weakness • muscle stiffness • restlessness in the legs or difficulty sitting still • uncontrolled muscle spasms, twitching, jerky or writhing movements • muscle aches or pain • joint swelling or pain • walking abnormally or with difficulty • abnormal posture, such as rigid body movements and persistent abnormal positions of the body <p>behavioural changes such as:</p> <ul style="list-style-type: none"> • irritability or agitation • unusual anxiety or nervousness <p>other changes such as:</p> <ul style="list-style-type: none"> • cold or "flu-like" symptoms e.g. cough, blocked or runny nose, sneezing, sore throat • feeling of tension or fullness in the nose, cheeks and behind your eyes, sometimes with a throbbing ache, fever, stuffy nose and loss of the sense of smell (signs of sinusitis) 	<p>Tell your doctor if you notice any of these less serious side effects and they worry you.</p>

Less serious side effects	What to do
<ul style="list-style-type: none"> • fever, chills, shortness of breath, cough, phlegm and occasionally blood (signs of pneumonia) • nosebleeds • tiredness, headaches, being short of breath when exercising, dizziness and looking pale (signs of decreased red blood cells) • discharge with itching of the eyes and crusty eyelids • unexplained weight gain • unexplained increase or decrease in appetite • indigestion, stomach discomfort or pain, diarrhoea or constipation • nausea or vomiting • dry mouth or excessive thirst • drooling • difficulty swallowing • acne • dry skin • dandruff • rash, red skin or itchy skin • thickening of the skin resulting in warts, corns, calluses • skin infection • swelling of any part of your body, e.g. hands, ankles or feet • inability to or feeling burning pain when passing urine • some loss of bladder control • bedwetting • frequent daytime urination in children • sexual function disturbances - problems with ejaculation • breast abnormalities - breast discomfort or swelling or unusual secretion of breast milk • missed or irregular menstrual periods • dizziness on standing up, especially when getting up from a sitting or lying down position • shortness of breath • chest pain or discomfort • an increase of CPK (creatine phosphokinase) in your blood, an enzyme which is sometimes released with muscle breakdown. These can only be detected by blood tests that your doctor may ask to be done. 	

Serious side effects

Serious side effects	What to do
<ul style="list-style-type: none"> • Hypersensitivity Reactions <ul style="list-style-type: none"> ○ severe or life-threatening rash with blisters and peeling skin that may start in and around the mouth, nose, eyes, and genitals and spread to other areas of the body (Stevens-Johnson syndrome or toxic epidermal necrolysis) ○ rash, itching or hives on the skin; shortness of breath, wheezing or difficulty breathing; swelling of the face, lips, tongue or other parts of the body <p>If you have them, you may have a serious allergic reaction to RISPERDAL.</p> • Signs of heart or blood pressure problems including: <ul style="list-style-type: none"> ○ fainting, blurry vision, light-headedness or dizziness particularly on standing that persists despite sitting or lying down again ○ very fast heart rate, slowed heart rate, heart rhythm irregularities • Signs of lung problems including: <ul style="list-style-type: none"> ○ sudden shortness of breath, trouble breathing, wheezing or gasping when you breathe, light-headedness or dizziness • Signs of high blood sugar or diabetes such as: <ul style="list-style-type: none"> ○ unusual thirst, tiredness, upset stomach or need to urinate more often than usual • Body temperature changes such as: <ul style="list-style-type: none"> ○ fever ○ unexplained high body temperature, excessive sweating or rapid breathing ○ severe muscle stiffness or fits • Tardive dyskinesia (uncontrollable twitching or jerking movements of the 	<p>Tell your doctor immediately, or go to Accident and Emergency at your nearest hospital if you notice any of these serious side effects.</p>

Serious side effects	What to do
<p>tongue, face, mouth, jaw, arms and legs)</p> <ul style="list-style-type: none"> • sudden weakness or numbness of the face, arms, or legs, especially on one side, or instances of slurred speech (these are called mini-strokes). 	

Tell your doctor or pharmacist if you notice anything else that may be making you feel unwell.

Other side effects not listed here may occur in some people.

Reporting side effects

After you have received medical advice for any side effects you experience, you can report side effects to the Therapeutic Goods Administration online at www.tga.gov.au/reporting-problems or in New Zealand at <https://pophealth.my.site.com/carmreportnz/s/>. By reporting side effects, you can help provide more information on the safety of this medicine.

Always make sure you speak to your doctor or pharmacist before you decide to stop taking any of your medicines.

7. Product details

This medicine is only available with a doctor's prescription.

What RISPERDAL contains

Active ingredient (main ingredient)	risperidone
Other ingredients (inactive ingredients)	<p>Tablets:</p> <ul style="list-style-type: none"> • lactose monohydrate • maize starch • microcrystalline cellulose • hypromellose • magnesium stearate • colloidal anhydrous silica • sodium lauryl sulphate • propylene glycol <p>The 0.5 mg tablets also contain titanium dioxide, purified talc and iron oxide red.</p> <p>The 2 mg tablets also contain titanium dioxide, purified talc and sunset yellow FCF.</p> <p>The 3 mg tablets also contain titanium dioxide, purified talc and quinoline yellow.</p> <p>The 4 mg tablets also contain titanium dioxide, purified talc, quinoline yellow and indigo carmine.</p> <p>Oral solution:</p>

	<ul style="list-style-type: none"> • tartaric acid • benzoic acid • sodium hydroxide • purified water
Potential allergens	Tablets: Sugars as lactose Oral solution: Benzoates.

Do not take this medicine if you are allergic to any of these ingredients.

What RISPERDAL looks like

RISPERDAL Tablets

You can identify RISPERDAL Tablets by their colour and shape. This is important because there are 5 types of RISPERDAL, each containing a different amount of risperidone:

- 0.5 mg brownish-red, film-coated, biconvex, half-scored oblong tablets marked with "Ris 0.5" on the scored side and "JANSSEN" on the other side (AUST R 71849)
- 1 mg white, film-coated, biconvex, half-scored oblong tablets marked "Ris 1" on the scored side (AUST R 47008)
- 2 mg orange, film-coated, biconvex, half-scored oblong tablets marked "Ris 2" on the scored side (AUST R 48486)
- 3 mg yellow, film-coated, biconvex, half-scored oblong tablets marked "Ris 3" on the scored side (AUST R 47010)
- 4 mg green, film-coated, biconvex, half-scored oblong tablets marked "Ris 4" on the scored side (AUST R 47011)

All strengths come in boxes of 60 tablets, except the 0.5 mg which comes in a box of 20 tablets.

RISPERDAL oral solution

RISPERDAL oral solution is a clear, colourless solution. It is packed in an amber bottle (30 or 100 mL) with a pipette which measures the dose in milligrams (mg) and millilitres (mL) (AUST R 56444)

1 mL of RISPERDAL oral solution contains 1 mg risperidone. The smallest amount you can measure with the pipette is 0.25 mL (0.25 mg) and the biggest amount you can measure with the pipette is 3 mL (or 3 mg).

Not all pack sizes are available.

Who distributes RISPERDAL

Janssen-Cilag Pty Ltd

1-5 Khartoum Road Macquarie Park NSW 2113

Telephone: 1800 226 334

NZ Office: Auckland, New Zealand

Telephone: 0800 800 806

This leaflet was prepared on 14 April 2025.